

# KL60 Density Meter



## Description

KL 60 Density Meters are used to monitor SF<sub>6</sub> gas density in sealed tanks. They are applied to indicate gas density. They are designed to monitor Medium Voltage systems.



KL60 Density Meter

## Features

- Bimetal temperature compensation ensures higher measurement accuracy.
- Suitable for indoor or outdoor installation.
- AISI 304 hermetically sealed stainless steel case.
- Gas connection tubes are made of AISI 316 stainless steel.
- The on-screen display value and output signals are independent of the impact of external environment, such as altitude.

## Application

- SF<sub>6</sub> Gas Insulated RMU
- SF<sub>6</sub> Gas Insulated Switchgear

## Options

- Process connection: customizable
- Measuring Medium: SF<sub>6</sub>, Air, N<sub>2</sub>, SF<sub>6</sub> + N<sub>2</sub> and other gases
- Suitable for High-altitude environment
- Wider temperature range: -40°C to +60°C
- Optional measurement accuracy: ±1.0%FS (+20±1°C) , ±2.5%FS (-20°C~ +60°C) (gas phase)

## Technical Parameters

Case diameter	64mm
Scale range	1 to 2bar abs
Accuracy	±1.5%FS (+20±1°C) , ±2.5%FS (-20°C~ +60°C) (gas phase)
Degree of protection	IP65
Ambient conditions	-20° C to +60° C, relative humidity ≤ 95%RH
Leakage rate	≤ 1 × 10 <sup>-9</sup> Pa·m <sup>3</sup> /s (Helium leakage inspection)
Process connection	M24 × 1.5 (customizable)
Installation method	Radial or Axial
Watch glass	Laminated safety glass
Impact rating	30g
Weight	≈ 0.2kg
Pressure element	Bourdon tubes

## Dimensions

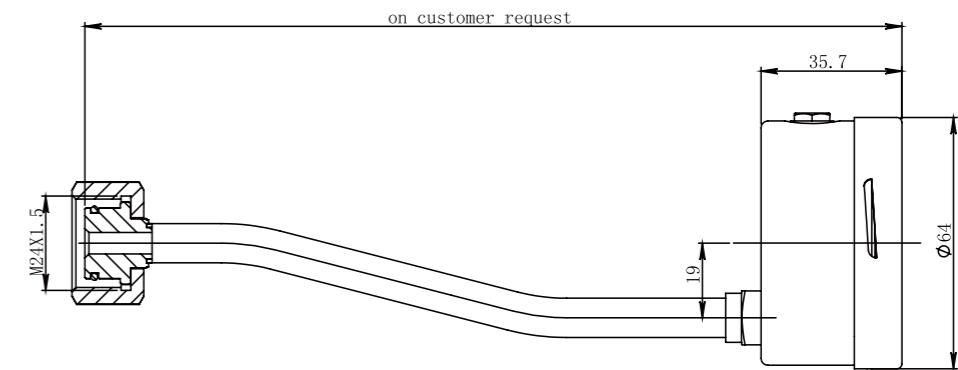

KL60 eccentric sample gauge size

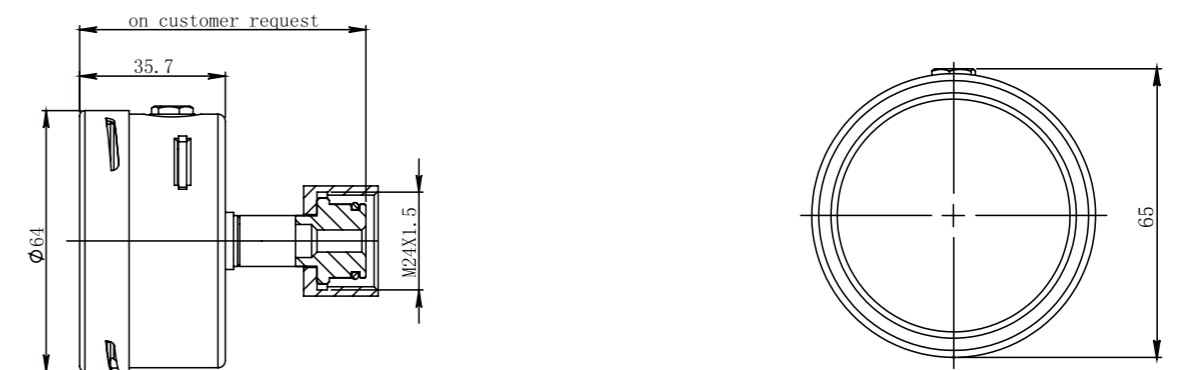

KL60 centerpiece sample gauge size